

## QUICK START :

1. Connect the safety valve at the inlet of water heater if supplied separately. Don't install water heater without safety valve.
2. Hook the water heater on wall with the help of mounting brackets. Take Necessary dimensions for making holes for mounting brackets.
3. Connect the inlet & outlet piping as marked on water heater.
4. Start water flow inside Water heater & fill it completely till water comes out from outlet connection.
5. Connect the electrical cord to power point.
6. Switch on the water heater's main supply, red indicator lamp comes on.
7. The red indicator lamp switches off indicates water inside the water heater reached to the set temperature
8. Run a complete cycle of Thermostat ON to Thermostat cut OFF, in presence of service provider / Installation technician / plumber.

## REBORN EVERYDAY WITH HOT WATER

Electric | Solar | Gas | Heat Pump



[www.racold.com](http://www.racold.com)

Ariston Group India Private Limited  
1<sup>st</sup> Floor, Office No. 103, Mayfair Tower,  
Wakdevadi, Shivajinagar Pune - 411005,  
Maharashtra, India.

Phone : +91 020 6764 5200

Customer care number:  
+91 20 6734 22 88, +91 8600 25 6000 | 7362 888 999

Email: [customer.care@racold.com](mailto:customer.care@racold.com)

## INSTRUCTION MANUAL

### OMNIS DG WI-FI

### OMNIS DG

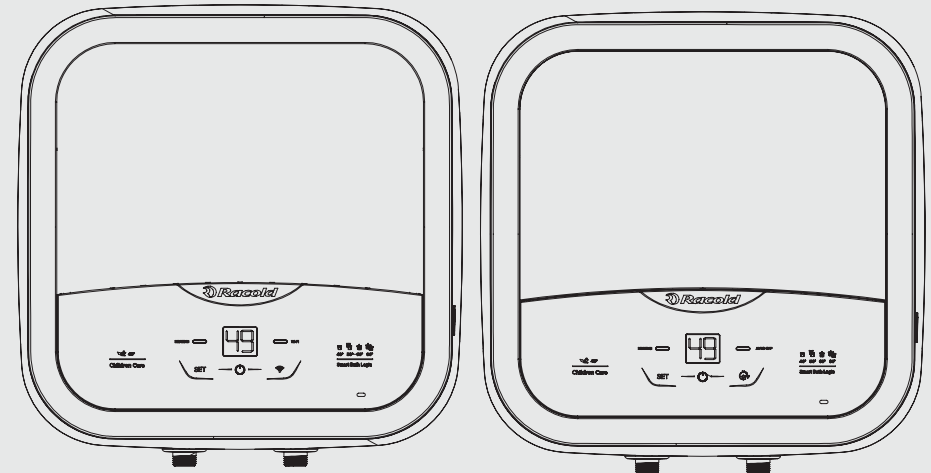

420011214601

## PRODUCT FEATURES :

1. High density PUF insulation.
2. Strong non-corrosive and durable PP outerbody and inspection cover.
3. Hi-tech thermostat and cutout, for double safety.
4. Titanium Plus Enameled & durable inner container with high pressure withstanding capacity enabling long life & suitable for high rise buildings and pressure pump applications.
5. 4 in 1 Multifunction Safety Valve.
6. Compact size.
7. Drip proof construction. 
8. Special flush mounting.
9. **Flexomix :**

During the use, every withdrawal of hot water from the water heater is then balanced by cold water coming in. The "Flexomix" technology provides better management of the cold water coming inside the water heater. The special flexomix deflector allows the water to mix more slowly, keeping the internal water temperature high and avoiding re-heating of water unnecessarily thereby saving precious electricity.

The flexomix system, with its new deflectors of water coming in, allows the user to draw upto 10% more hot water than a traditional water heater of the same capacity.

### 10. Silver ion:

The Ag+ cartridge technology by Racold have the added advantage of an antibacterial capability, and actively stop the proliferation of E-coli, Salmonella, Legionella, Mould Fungi & more. Silver spheres placed inside the tank in a specifically designed cartridge, at the level of the water inlet pipe, allowing the water contained in the tank to receive bacteriostatic effect by contact with Ag+ spheres. Available in Omnis Wifi model.

## KNOW YOUR WATER HEATER :

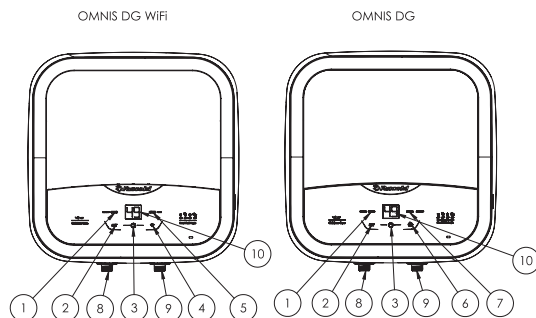

## IMPORTANT INSTRUCTIONS :

Ariston India Pvt. Ltd. cannot be held responsible for the damages caused by wrong installation, faulty material, using substandard water or for not following instructions included in this instruction manual, particularly :

1. Installation of the water heater should be done by qualified personnel only.
2. In case the installation is being done on a wall with hollow bricks, refer 'Preparation for Installation' Page 6.
3. Use pressure reducing valve incase rated water pressure is higher than recommended.
4. The electrical connection should be in accordance with the instruction given, refer Page 7.
5. The safety valve supplied with the water heater should be fitted to the inlet connection and should not be disturbed with. For servicing safety valve, refer 'Safety Devices' Page 4.
6. When newly installed, make sure that the water flows freely from the outlet tap (or spout) before electric supply is switched on.
7. Inlet water line should be continuously open when water heater is in use except when it is being serviced.
8. Switch off water heater when not in use to save electricity charges.
9. In case a dead weight safety valve is being used it should be serviced regularly.
10. It is recommended that the IN/OUT pipes and heating element be de-scaled at least once in a 6 months.
11. While using the water heater first time, ensure water is dispensed through outlet before switching ON product. Failure to do so will cause damage to heating element.
12. As per safety norms, Thermostat & Cut out are set at desired temperature & its recommended not to change the setting.
13. As per safety norms, Safety Valve is set at desired Pressure & its recommended not to change the setting.
14. Optimum performance of the water heater is achieved when the total hardness of water <400 ppm & chloride content < 300 ppm.

1. RED LAMP (Heating ON)
2. SET SOFT TOUCH BUTTON
3. PRODUCT ON/OFF BUTTON
4. WIFI ON/OFF SOFT TOUCH BUTTON
5. BLUE LAMP ( Indicate WiFi mode ON )
6. AUTO OFF SOFT TOUCH BUTTON
7. BLUE LAMP ( Indicate AUTO POWER OFF function ON)
8. OUTLET PIPE
9. INLET PIPE
10. TEMPERATURE DISPLAY



Reborn Everyday With Hot Water

Dear Customer,

Thank you for choosing a world-class product from Ariston Group India Private Limited. Your choice for nothing but the best is reflected by your trust placed in Ariston. Racold is registered trademark of Ariston Spa Italy.

Ariston Group India Private Limited is a fully owned subsidiary of Ariston Spa Italy, and part of the Ariston Group the leaders in water heater.

Today Ariston Group India Private Limited is the largest provider of water heating solutions in India, catering to all sectors water heating namely " Electrical, Gas, Solar and Heat Pump water heaters"

The Racold range of products from Ariston Group India Private Limited have changed the industry standards by setting new benchmarks in quality, aesthetics and performance.

Our many firsts in India include :

- Water heater with rust proof polypropylene body.
- Stainless steel inner container with multi-function safety valve for high Pressure operation without additional pressure reducing valve.
- PUF insulation for maximum energy saving.
- Energy labeling for any domestic electrical appliances.
- Only water heater with quality and performance certification as per IEC/EN and Indian standards (ISI mark).
- Won highest number of National Energy Conservation Award from BEE (Bureau of Energy Efficiency) for electric storage water heaters.

Retain this manual safely and in case you need any assistance you may get in touch with any of our customer care centres, the details of which are enclosed.

Kindly follow the instructions given in this manual and enjoy years of trouble free performance.

For further information including but not limited to FAQs, relevant products, please visit our website by scanning this QR code.





Please complete the following details:

Product: ELECTRIC STORAGE WATER HEATER

Model No: \_\_\_\_\_

Serial No: \_\_\_\_\_

Purchaser's Name & Address: \_\_\_\_\_

Dealer's Name & Address : \_\_\_\_\_

Dealer's Signature : \_\_\_\_\_

Cash Memo No: \_\_\_\_\_

Date of Purchase: \_\_\_\_\_

The Racold water heater comes with warranty for a period of two years from the date of purchase against electrical or mechanical failure caused through defective material and workmanship. The warranty for OMNIS DG WIFI, OMNIS DG model is 7 years for inner container against leakage & 4 years for heating. In event of failure covered by this warranty, you are requested to contact our customer care & obtain the complaint number. Our trained technicians will repair the product at our option. No further liability for the consequential or damage is accepted or implied. We will not be responsible for any human injury, property damages consequential damages caused due to improper use. All disputes will be subjected to Pune Jurisdiction only. The warranty on the tank includes the tank only. It does not include any other parts inside or outside of the tank.

- 1) Annual check of anode is done mandatorily and its replacement done in case of consumption ( rod diameter less than 7 mm)
- 2) Warranty will be no more valid in case the maintenance of anode is not done as per point no 1

**Following things shall not be covered under warranty :**

- Any plumbing and/or Electrical related problems, not related to product.
- Any defects arising due to wrong and/or non recommended installation procedure.
- Dry heating of water heater.
- Consumables such as anode.
- Any human injury, property damages and consequential damages caused due to improper use.



**SAFETY DEVICES :**

**A. Multi functional Safety Valve : (Non-Return Valve / Vacuum Release Valve / Pressure Release Valve / Drain Valve)** Non-return function will not allow the back flow of hot water from inlet. In-built multifunction safety valve (Pressure relief valve) is set to operate between 7.5 bar (109 p.s.i.) and 8.5 bar (123 p.s.i.) Vacuum relief valve prevents the formation of vacuum inside the container. Drain lever (L) is provided to drain the water heater only in case of servicing. Check for any leakage before switching on electric supply. In case of safety-valve dripping during normal use, connect a discharge pipe (P) (as shown) for piping away the relieved water. In a continuously downward direction and in a frost-free environment. **In case copper Pipe plumbing is done, additional 1/2 inch connector or adaptor to be connected to avoid safety valve damage by copper pipe.** Contact nearest service centre for discharge pipe availability.

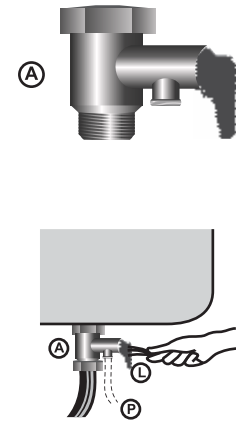

Fig. 2

To avoid deposition of limes in the safety valve, please move the lever (L) up & down few times. This should be done at least once in a month. Minimum water head of 50cms. is required at inlet for water to enter inside the container.

Note: The rated pressure is developed inside the tank after heating at outlet pipe. It is recommended to maintain approximately 1.5 bar pressure at inlet pipe.

**The safety valve (A)** should be serviced at least once a month. Before servicing the safety valve, ensure that the water heater is switched off and water inside is not hot. Connect the discharge pipe (P) in a downward sloping position to the safety valve at the discharge hole provided. The water may drip from the discharge pipe of the pressure relief device and that this pipe must be left open to the atmosphere. A discharge pipe connected to the pressure-relief device is to be installed in a continuously downward direction and in a frost-free environment.”

**B. Thermostat :**

Hi-tech adjustable thermostat with automatic ON-OFF indication on display of control panel and variable setting of temperature. The temperature of water at which the thermostat will cut off can be adjusted by setting the control panel to the desired temperature. This should be kept as low as possible, consistent with hot water demand. Scale formation in water heaters can be limited if due care is given to the temperature. The thermostat (NTC) can be withdrawn without having to drain the water and in the installed position.

**C. Thermal Cutout :**

Hi-tech thermal cutout non-self resetting type set to disconnect electrical supply through two poles for extra safety. Please contact qualified service personnel in such an event.

**HEATING ELEMENT:**

**Self cleaning heating element :**

The heating element is made of best anti-corrosive material & guarantees absolute isolation between electricity & water.

Racold's self-cleaning Heating Element made of a special stainless steel alloy that has a specially treated surface (brightened). The self cleaning Heating Element has proved to be an extra help for **low energy consumption & for a longer life of the inner tank.** Thanks to its smooth & bright surface, the lime stone does not lay on the heating element thus allowing the heat to be efficiently exchanged with the water, **even after long period use.**

## OPERATION INSTRUCTIONS :

1. Switch on the water heater's main supply, red indicator lamp comes on.
2. The red indicator lamp switches off indicates water inside the water heater reached to the set temperature.
3. The Red indicator lamp, which is ON during the normal operation, goes OFF when the thermal cut-out is activated. Contact qualified service personnel in this event.

### TECHNICAL SPECIFICATIONS:

MODEL	OMNIS		
	10 L	15 L	25 L
Capacity (Ltrs.)	10 L	15 L	25 L
Power supply	230 Volts AC, 50Hz, Single Phase		
Wattage (kW)	2	2	2
Reheating time for 50°C temp.rise,(minutes) Max.	20	30	50
Mean hot water output temp.(°C) Min.	60	60	60
Mixing factor (%) Max.	10	10	10

**Maximum rated pressure -**  
8.0 Bar /800000 Pascal / 0.80MPa / 80N/cm<sup>2</sup>  
/ ~80m Water Head

**Minimum inlet water pressure -**  
5000 Pascal (0.05 bar) for all models

**IP rating -** IP 23 for all models

## PREPARATION FOR INSTALLATION :

1. For the installation of this water heater you need to prepare the wall suitably and more so if the wall is constructed out of hollow bricks.
2. For solid bricks the usual method of installation of drilling holes in the wall and securing bolts in the right position with the help of cement concrete can be adopted, use M8 x 75 mm bolts.
3. However for hollow bricks the following procedure should be adopted :
  - ⇒ Dig up sufficient space to accommodate the wall mounting bracket supplied with this water heater, upto a minimum depth of 80mm and fill up the complete space with cement concrete.
  - ⇒ After the cement concrete is properly set the wall bracket can then be secured to the wall with the help of bolts. It is very important to put the wall bracket only after the cement concrete has set in.

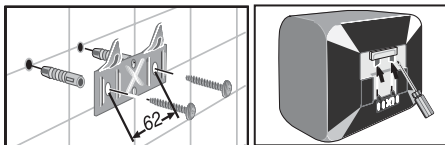

## SPECIFICATIONS :

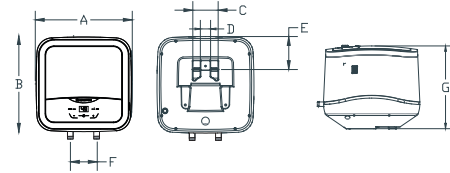

Capacity	A	B	C	D	E	F	G
10L	400	400	94	38	155	100	292
15L	400	400	94	38	155	100	340
25L	447	447	94	38	143	100	401

### NOTE :

- a) All dimensions are in 'mm'
- b) "E" represent the distance between top of product to mounting positions. (back side)

## INSTALLATION :

### Mounting and Plumbing

1. Wall mounting bracket is supplied with the water heater.
2. Mark the position of the bolts on the wall, after checking the same with the mounting bracket supplied with the water heater.
3. Hook the water heater to the mounting bracket fix on wall and pull down the water heater slightly by hand to cause firm gripping in the hook of the bracket.
4. The cold water inlet pipe is circled with a blue collar while the hot water outlet pipe with red collar.
5. Fix 1/2" BSP union coupling on inlet and outlet connections.
6. Make necessary plumbing with the reference of the installation diagrams shown.
7. Ensure proper ventilation where the water heater unit is been installed.
8. In case of water dripping from safety valve, please put drain pipe (as shown in Fig.2)
9. Product must be installed in a such a way that it should be easily accessible for servicing

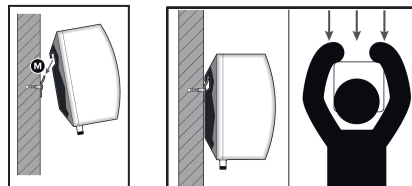

## PRECAUTIONS

1. In order to avoid a hazard due to inadvertent resetting of the thermal cutout, this appliance must not be supplied through an external switching device, such as a timer, or connected to a circuit that is regularly switched on and off by the utility.
  2. In case a pressure reducing valve (or a non-return valve) is used in the installation, please ensure that it is installed at a minimum distance of 12 feet from the inlet point. Installing the PRV (or NRV) without respecting this minimum distance may cause safety valve dripping.
  3. The new hose-sets to be used and that old hose-set should not be reused.
  4. This appliance can be used by children aged from 8 years and above and persons with reduced physical, sensory or mental capabilities or lack of experience and knowledge if they have been given supervision or instruction concerning use of the appliance in a safe way and understand the hazards involved. Children shall not play with the appliance. Cleaning and user maintenance shall not be made by children without supervision.
  5. If the supply cord is damaged, it must be replaced by a special cord or assembly available from manufacturer or its service agent having same electrical rating and specification.
  6. Please use a 3 pin plug of 16A rating for electric connection & ensure secure connection of the earthing wire.
  7. Please ensure to mount the water heater keeping sufficient space on the left hand side (~350- 400 mm). This will facilitate easy servicing product without dismounting.
- Maintenance**
- The anode should be checked within 12-18 months from the installation. If the diameter goes below 7 mm, it should be replaced with a new anode (this operation should be performed by authorised personnel).

## IMPORTANT

This warranty is valid subject to installation of the unit as per the instruction manual and the conditions stated there in. This warranty will not apply to any Racold Water Heater which has been tampered with or altered in any way or which has been subjected to misuse, negligence or accident.

For water heaters installed at inaccessible places such as above a false ceiling, inside a duct etc. It is the responsibility of the customer to dismantle the product and make it available to the service representative. Its recommended to take AMC & Extended warranty from Racold's authorized service franchisee.

We recommend to use genuine Racold spare parts only.

Visit charges shall be applicable for product installation, demonstration & explanation related calls.

## WARNING MARKING

The instructions shall include a warning that the appliance shall be disconnected from its power source during service and when replacing parts and, if that the removal of the plug is foreseen, it shall be clearly indicated that the removal of the plug has to be such that an operator can check from any of the points to which he has access that the plug remains removed."

## CAUTION MARKING

In order to avoid a hazard due to inadvertent resetting of the thermal cut-out, this appliance must not be supplied through an external switching device, such as a timer, or connected to a circuit that is regularly switched on and off by the utility."

### Correct Disposal of this product



This marking Indicated that this product should not be disposed with other household wastes throughout the EU. To prevent possible harm to the environment or human health from uncontrolled waste disposal, recycle it responsibly to promote the sustainable reuse of material resources. To return your used your device, Please use the return and collection systems or contact the retailer where the product was purchased. They can take this product for environmental safe recycling.

## ERROR / AUTO DIAGNOSYS

In case of error the display shows automatically the text "Er" and alternately the error code as shown in the table below. At the same time all Leds blinks to indicate the error status

Error Description	Error Codes	Actions
Dry Heating Error - empty product	25	Be sure the product is filled with water before restart. The reset of the safety thermostat, inside the product, should be done authorized personnel only.
Temperature exceed the admitted limit	21	Try to reset by pressing On/Off button if the error persists call Service Center to restart the appliance after the reset of the safety thermostat (inside the product).
Internal Error of Electronic	01	Switch the product Off than On again, if the error persists call Service Center
Internal Error of Electronic	09	
Temperature sensor damaged	20	Call Service Center
Internal Error of Electronic (NFC data)	62	Switch the product Off than On again, if the error persists call Service Center
Internal Error of Electronic (Touch buttons)	63	
Internal Error of Electronic (WiFi communication)	60	
Internal Error of Electronic (NFC communication)	61	

As seen in Fig. 5, a Dead Weight Valve can also be fitted at the outlet connection as a double safety measure against positive pressure above the rated pressure (8 Bar) Please ensure that adequate arrangement for piping away the relieved water is made. Dead weight valve is available as an extra option. For servicing, lift the dead weight valve to ensure easy flow of water from the relief tube. This should be done atleast once in a month.

Please ensure that the pressure in the water heater is less than the rated pressure. Install pressure reducing valve at the inlet as shown in Fig. 5.

PRV should be installed at a minimum distance of 12 feet from the inlet pipe, to avoid safety valve dripping.

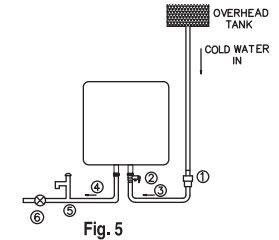

- Fig. 5
1. Pressure Reducing Valve (PRV)
  2. Multi-function safety valve (MFSV)
  3. Cold water Inlet
  4. Hot water outlet
  5. Dead Weight Valve (DWV)
  6. Stop Cock (SC)

## MAINS CORD :

- 3 Pin Plug, 3 Core x 1.0 Sq. mm (32 x 0.2) PVC Sheathed, 16A, 250V with ISI mark certified for Omnis 2 Kw products.

**Note :** Main's cord or any other electrical component must be repaired / replaced by authorized service personnel only. Minimum Contact separation of 3mm is required in all poles for disconnection.

## WIRING DIAGRAM :

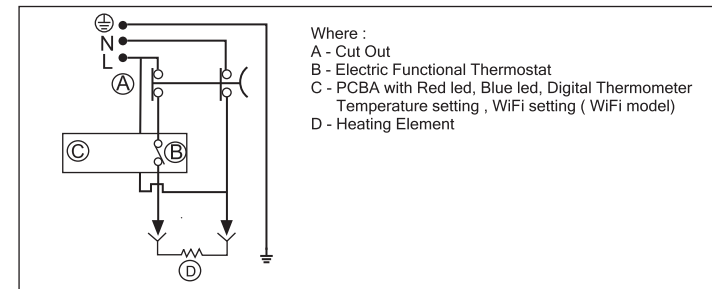

## TROUBLE SHOOTING GUIDE FOR WATER HEATER:

#	Problem / Observation	Possible causes	Solution / Remarks
1	Water Heating takes longer time than specified in Instruction manual	Scaling on the Heating Element cause slower water heating	Get the Heating element de-scaled from authorised service person or replace with genuine spare parts recommended by company Measure the temperature of water using thermometer. Adjust the flow rate at 3 Ltrs/min
		Low voltage at certain places	Check the voltage at customer's place
2	Equipment creates abnormal Noise	High voltage fluctuations, Hard water	Recommend Spare HE with low watt density (8W/cm <sup>2</sup> )
	Equipment creates hissing Noise	Due to scaling on HE	descaling HE
3	Unit not working	Power point may not be working	Need the line at customer's place to be checked
		Check for any short circuit of harness/Power cord inside	
		Cut out operated due to dry heating	Reset Cut out
		Heating Element might not be functioning (may be due to Dry heat or short/Crack/burst/heavy scaling)	Replace HE
4	Leakage of the unit	Rusting of the tank	Check from where the leakage is (tank, collar, gasket, HP), Replace or repair based on the observation
		Not enough torque to the bolts on HP / HE flange	Replace or repair based on the observation
		Leaking from HE Brass flange (instant WH)	Replace HE
5	No Hot water out put	HE not working	Reset Cut out
		Thermostat low setting (check if someone tampered the setting in Instant water heater)	
		Cut out trip	
		Inlet valve closed	Open the inlet valve
6	User gets mild shock when using WH	Improper earthing at customer's place	Check for proper earthing & if not then suggest customer to do it properly
7	Outlet water blockage	Heavy scaling on Outlet pipe opening end	descaling the product from authorised service personnel
8	Leaking from MFSV (Safety valve)	Excess pressure than rated pressure	Check the pressure when unit is in ON condition, ensure Inlet line is ON. <b>Note</b> When MFSV is dripping, it ensures safety of the equipment from excess pressure. Put drain pipe at MFSV with clip
		Check NRV position from inlet pipe	It should be minimum 12 feet from equipment
			Check if PRV is there in high rise building
9	Water Heater unit burnt	Short circuit of the harness / Power Cord	Replace Harness asm or Power Cord
		Use of Low amp Power Cord	
10	Smell comes out of water	If Water heater unit is not used in 15+ days, water inside smells for some time	Flush out 2 times capacity of water heater.

## WIFI APP FUNCTION/ FEATURE

**Voice-enabling:**  
The App is compatible with all the main voice assistants available on the market.

**Weekly program:**  
The weekly program function can be activated only via the APP. There is no feedback on the HMI that this mode has been selected. The user can select for each day of the week two different set point temperatures at two different times.

If the set point temperature is modified, ECO function or Auto Power Off is selected, the WEEKLY PROGRAM will be deactivated

**Auto-diagnosis:**  
Error notification (if any) with the error code and descriptions on the App

**Energy consumption monitoring:**  
The app tracks daily, and monthly energy usage to provide a report with the history available. Customized tips on energy saving are provided whenever connects to the app

## NEW AUTO POWER OFF FUNCTION

With the new function the product automatically turns off after a pre-selected timing by the user:

Press the button [AutoPowerOff] to activate the function - Blue light and display will blink during this step.

Press [SET] to select desired timing of deactivation (15, 30, 60, 90 minutes). 30 minutes is the default timer for first time setting - Blue light and display will blink during this step.

To exit the "Set mode" wait for time out (5 seconds) - Count down will start after the set point temperature is reached. During the selected timing the product keep the temperature of the water at the selected set point before switching off. To disable the function, press the button [AutoPowerOff] at any time.

After product switches off automatically:

- Press [On-Off ] button to reactivate the product and the AutoPowerOff function will be On again with the last setting.

- Press the main switch (on the wall) OFF for at least 3 seconds and ON again. The product will turn on (heating on), with AutoPowerOff function.

## ANTIBACTERIAL FUNCTION

The product runs automatically a self-cleaning cycle at 65°C of temperature, for 1 hour, to prevent the formation of bacterial inside the tank in case the water heater is not used for a long time.

The cycle will be executed only if the selected temperature is below 60°C.

If the function is activated, the cycle will run each time the product is powered (by main switch) and it is repeated every 30 days. This function is disabled by default, can be enabled by pressing together buttons [SET] & [ON-OFF] for 3 sec. The display will show momentarily "A1". To disable press again, together, the buttons [SET] & [ON-OFF] for 3 sec. The display will show momentarily "A0". When anti-bacterial cycle is in progress the display shows "Ab".

## ANTI-FREEZE FUNCTION

The Antifreeze function prevents ice formation inside the tank. If water temperature goes below 5 °C, the heating element will be switched on until a protection value is reached. When antifreeze protection is in progress the display shows "AF".

## ECO FUNCTION

The Eco function aims to produce hot water by learning the user habits. For the first week ever the product memorizes the water withdrawals and the periods in which those withdrawals take place. From the following week the water heating is performed based on what learned previously. If the user wants to reset the function and start a new learning period, it is necessary to reset the function, as explained below.

If temperature is modified or Weekly Program Mode is selected (for WI-FI products) the Eco function is automatically disabled.

The function is disabled by default.

Standard version: The function can be activated by the user interface pressing together buttons [SET] & [AutoPowerOff] for 3 sec. The display will show momentarily "E0" if the function has been disabled or "E1" if enabled.

WiFi version: The function can be enabled/- disabled by the APP or can be activated by the user interface pressing together buttons [SET] & [WIFI] for 3 sec. The display will show momentarily "E0" if the function has been disabled or "E1" if enabled.

All data stored by the ECO function are lost after 2 hours without power supply or can be erased manually.

Standard version: pressing together buttons [SET] & [AutoPowerO] for 5 sec. The display will show momentarily "E-" to confirm the data has been canceled.

WiFi version: pressing together buttons [SET] & [WIFI] for 5 sec. The display will show momentarily "E-" to confirm the data has been canceled.

## DOs AND DON'Ts OF WATER HEATER :

#	DOs	Remarks
1	Installation of water heater should be done by qualified person only preferably from Racold service	Product warranty will get void in case of wrong installation
2	Use pressure reducing valve in case rated water pressure is higher than recommended	To Avoid Water dripping from safety valve.
3	Inlet water line should be continuously Open when water heater is in use except when it is being serviced	
4	Ensure proper leveling of the unit while doing Installation	If tilted, it may affect the hot water output quantity
5	Ensure proper earthing at the place of installation	Chances of getting Shock
6	Use ISI marked or Branded company Power Plugs only.	Use 16 Amp Power Plug only
7	Use of two spanners suggested while installing the product (connecting the hose pipes)	There may be a chance of crack on the pipes if we don't do so
8	Ensure water coming out from outlet prior switching the unit ON (first time)	If no water inside tank, unit goes into dry heat causing damages, burning etc.
9	It is mandatory descale IN/OUT pipes, heating element and safety valve at least once in 6 months when water hardness is greater than 400 ppm. If lower (1) this type of maintenance is recommended. Operation must be done only by Racold authorized Service (Intervention charge shall be applicable)	This helps in Improving product life.
10	As per the safety norms Thermostat, Cut out are set at desired temperatures and Safety Valve set at desired pressure and its recommended not to change the settings	Product warranty will get void if setting changed.
11	Power OFF the unit while servicing the water heater unit	Chances of product burning/Safety purpose
12	Use Only Genuine company spare parts from authorised service centers	Product warranty will get void if used other than company recommended spare parts
#	DON'Ts	
1	Use connectors in case if is required to connect another cord with main power cord came along with the product	Chances of product burning/Safety purpose
2	Do not tamper the thermostat setting	As per safety standards, thermostats are set at desired temperatures. Recommend not to change the settings
3	Do not switch ON the product without checking the water coming out from outlet	Chances of product burning
4	Do not adjust / disturb Safety valve setting	As per safety standards, Safety valve are set at desired pressure. Recommend not to change the settings.

## IMPORTANT NOTES :

- Optimum performance of the water heater is achieved when the total hardness of water <400 ppm & chlorides content < 300 ppm.
- In case a pressure reducing valve (or non return valve) is used in installation, please ensure that it is installed at a minimum distance of 12 feet from the inlet point.
- Please ensure the installation of water heater to be done by keeping minimum 1 foot from the wall on either side.
- Anode should be checked periodically within 6 months. If the anode goes below 7mm diameter, replace it by authorized service personnel on at chargeable basis.
- In case of product installed at inaccessible place, it is responsibility of customer to dismount the product and make it available to the service representative.
- AMC- it is recommended to take AMC and extended warranty from authorized service franchisee.
- Visit charges shall be applicable for product Installation, Demonstration & explanation related calls.
- Please ensure proper ventilation whenever the unit is installed to avoid any rust formation/aggregation.

## Electric Water Heater Installation Guidelines for Plumbers

- Read Instruction Manual carefully and follow installation instructions.
- Safety valves are pre-set for certain working pressure. Under any circumstances do not tamper / over-tighten the safety valve.
- Continuous water dripping from Safety valve is an indication of excessive pressure at inlet of water heater compared to the rated pressure. In that case install pressure reducing valve at the inlet
- Check for leakages after installation, plumbing & before switching ON the power supply.
- Ensure flow of water from outlet before connecting electric power supply to the appliance.
- Do not use excessive force while tightening Inlet and outlet Couplings. This may cause serious damage to the Water Heater. Use Cross spanner for tightening.
- Check supply voltage at the place of installation 230V.
- Ensure proper earthing of electrical connection.
- No extension cords to be used.
- Use only ISI marked electrical accessories of proper rating e.g. 3 Pin Plug, Connection Boxes, Wires etc.
- In Storage water Heaters, check whether red lamp is glowing when the water heater is switched on.
- Ensure all Couplings / Joints are leak-proof.
- Check the Water Heater operation for one complete cycle i.g. one cycle of Thermostat operation, i.e Cut-off and cut-in

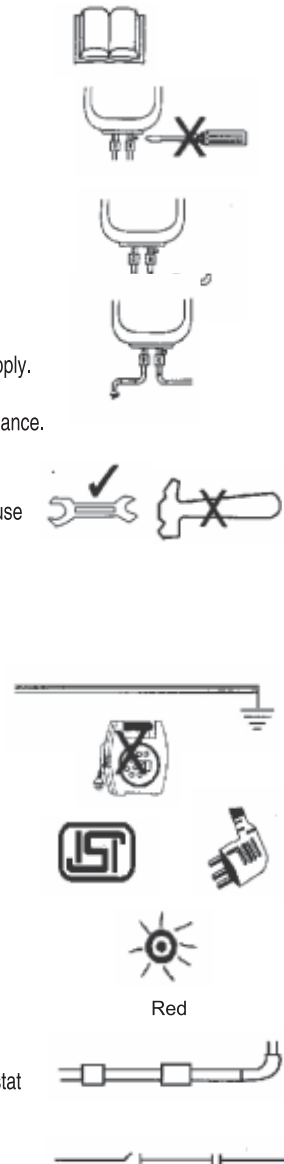

## INSTRUCTION FOR THE USER

Standard version



Wi-Fi version



Led & Buttons	Functionalities
1 – On/Off button	Press to switch ON or OFF the product
2 – Set button	Press to regulate the desired temperature from 40°C to 80°C
3 – AutoPowerOff	Press to activate / deactivate the function. Note: check the specific paragraph of this manual to operate with this function
4 – Wi-Fi button	Press to activate / deactivate Wi-Fi Press for 5 sec. to activate Access Point (to connect to router Wi-Fi) Press for 10 seconds to reset Wi-Fi Note: check the specific paragraph of this manual to operate with WiFi
5 - Heating Led (Red)	Led is On when the product is heating the water
6 – AutoPowerOff Led (Blue)	Led is On when the AutoPowerOff function is activated
7 – Wi-Fi Led	Led ON when Wi-Fi is activated and connected Led OFF when Wi-Fi is deactivated Led blinking slowly: Wi-Fi ON, not connected Led blinking fast, Access Point activated Led blinking ultra-fast when Wi-Fi is reset
8 – Digit Display	The display shows normally the internal average temperature of the hot water. During the regulation of the temperature the display shows the set point temperature. During the AutoPowerOff activation the display shows the available timer options.

### SWITCH-ON THE PRODUCT

Every time the product is powered by the external switch or the main cord, the appliance performs a self-check and all Leds are switched ON and the display shows the text "nF" for 1sec. to verify the loading of NFC parameters.

### TEMPERATURE SETTING

The temperature can be regulated by the button [SET].

Press the [SET] button several times or keep it pressed until the required temperature is showed on the display.

Once nished, the display will show again the average internal temperature of the water